



Kirk Sandall Industrial Estate, Doncaster, South
Yorkshire, DN3 1QR

+44 (0)1302 310 113
enquiries@prosolveproducts.com
www. prosolveproducts.com

ProSolve is trademark of S.T.L Trading Company
Limited
Reg in England No: 5230722
VAT Reg No: 381 3533 58

SAFETY DATA SHEET

ProSolve™ Hi-Vis Marker Spray

This product can be used in all position thanks to its special 360° valve. This spray is resistant to weathering and wear and is ideal for professional uses on surfaces such as asphalts and walls, but also for domestic use on woods and floors. It's available in different colors (including fluorescent).

TECHNICAL SPECIFICATIONS

Quantity	500 ml
Box / Case	12 Pz.
Aspect	Tin-Plate can containing under pressure fluid
Chemical Nature	Synthetic modified resin
Colour	Fluo-pastel
Odour	Characteristic of solvent
Relative Density	At 20°C 0,70÷ 0,74 g/ml
Writings On The Bottom	Barcode, date of production, name of product
Flash Point	Und. 0° C extremely flammable
Pressure	at 20°C 5,5 ± 0,5 bar
Pressure	at 50°C 8,0 ± 0,5 bar
Viscosity Ford Cup	From 28" to 33"
Dry Residual In The Can	From 30 to 35 %
Overcoating	Every time
Brilliance	From 0 to 15 Gloss (60 ° angle gloss meter)
Operating Temperature	-10°C / +100°C (Picchi 150° C)
Safety cap child-proof patented.	
The product is permanent and resistant to UV rays and humidity.	

Directive 2004/42/CE: C.O.V.

Under category: Special finishing Limit value COV: 840 g/ Litre Max effective contents:640 g/Litre



FIELDS OF APPLICATION:

Surfaces in wood, surfaces in metal concrete, walls, asphalt

HOW TO USE

1. Open the cap: Break the safety seal to open the cap. Rotate the coloured tongue that covers the provider clockwise.
2. Shake emphatically the cylinder for at least 1 minute, up to feel the inside marbles freely stir. It's advised shake desultorily the cylinder during the use.
3. Use the product: Spray at any angle you want.
4. Rotate the coloured tab that protects the provider counter-clockwise.

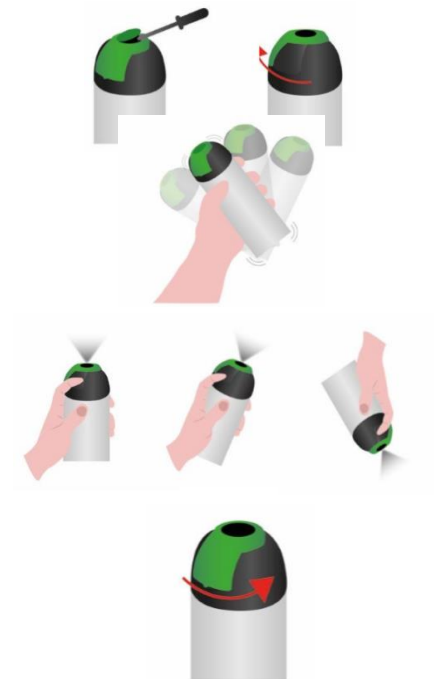

MODALITY OF STORAGE

Before using: stock the product in a dry location and don't stock it with a temperature under 5°C and over 45°C, after the use, keep containers closed. In the original package, the product can be conserved for 24 months (warranty). The product doesn't expire. After the first usage: conserve in a fresh and dry location, away from hot spring. Keep out of reach of children.

This information, even if reliable, must be considered only approximate. We are not responsible for the wrong use of the product, or the violation of any license. Before using, the users should verify the suitability of the product for its specific use.

IMPORTANT NOTICE

All statements, technical information and recommendations are based on tests we believe to be reliable as at the date of hereof, but the accuracy or completeness thereof is not guaranteed. Please ensure before using the product that it is suitable for your intended use. Since the conditions and methods of use of the product and of the information referred to herein are beyond our control, other than for fraudulent misrepresentation, ProSolve expressly disclaims any and all liability as to any results obtained or arising from any use of the product or reliance on such information.

BEFORE USE, CONSULT THE SAFETY DATA SHEET OF THE PRODUCT.